



Front Load

Item #: _____ Qty #: _____

Model #: _____

Project #: _____

FEATURES:

Curved top design.

Heavy duty welded construction with 6 cross supports.

Nickel chrome plated steel wire.

Heavy duty 5" stem bolted casters.

500 lb. capacity.

CONSTRUCTION:

Fully welded 1" square tubing ladder assembly.

Angles are 1" x 1 1/2" x 20" on front load pan rack and 1" x 1 1/2" x 17 3/4" on side load pan rack.

MATERIAL:

6063-T52 extruded aluminum angles, upright tubing, and support pieces.

Nickel chrome plated steel wire.



Side Load

MODEL #	Description	Pan Capacity	Shelf Spacing	Overall Size L x W x H	Weight
WR-36	Front Load	36	1 1/2"	20 1/4" x 25" x 70 1/4"	72 lbs.
WR-36S	Side Load	36	1 1/2"	28 1/4" x 19 1/8" x 70 1/4"	64 lbs.

TOL $\pm .500''$

Front Load

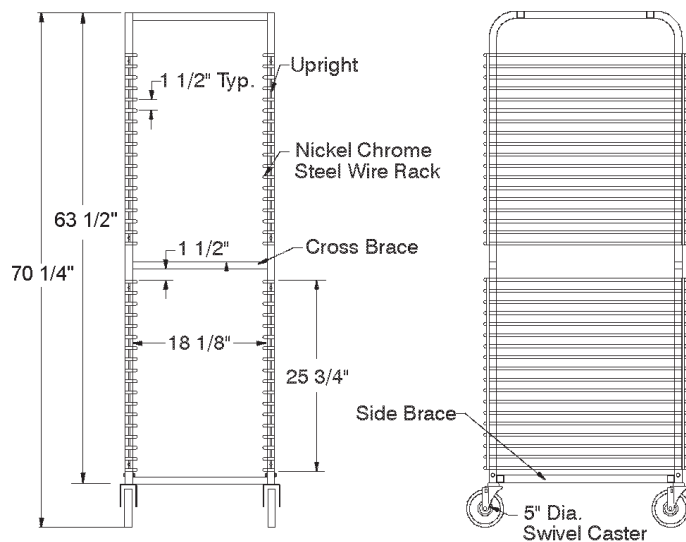
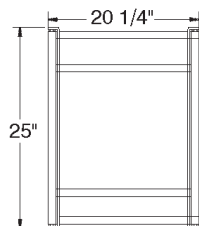

Side Load

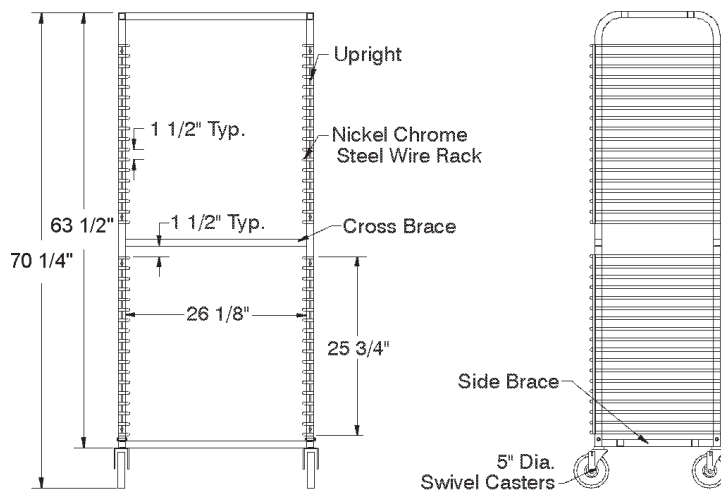
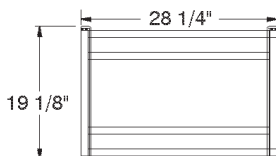

© ADVANCE TABCO, NOVEMBER 2019