



Stainless Steel Ice Bin Covers

For SLI & CRI Series Ice Bins



Item #: _____ Qty #: _____
 Model #: _____
 Project #: _____

NOTE: All Bottle Racks Must Be Removed To Use Ice Bin Covers

FEATURES:

All stainless steel construction.
 Easy to open and close with front-to-back sliding motion.

MATERIAL:

20 Gauge type 300 stainless steel

Model #	Size W x L	Description	Approx. Weight	Approx. Cu. Ft.
SSC-12	16-1/4" x 10-3/4"	For 12" Ice Bin	5 lbs.	1
SSC-18	16-1/4" x 16-3/4"	For 18" Ice Bin	6 lbs.	1
SSC-23*	16-1/4" x 21-1/2"	For 24" Ice Bin	6 lbs.	1
SSC-24	16-1/4" x 22-3/4"	For 24" Ice Bin	7 lbs.	1
SSC-29*	16-1/4" x 27-1/2"	For 30" Ice Bin	7 lbs.	1
SSC-30	16-1/4" x 28-3/4"	For 30" Ice Bin	8 lbs.	1
SSC-35*	16-1/4" x 33-1/2"	For 36" Ice Bin	9 lbs.	1
SSC-36	16-1/4" x 34-3/4"	For 36" Ice Bin	9 lbs.	1
SSC-42	16-1/4" x 40-3/4"	For 42" Ice Bin	10 lbs.	2
SSC-48	16-1/4" x 46-3/4"	For 48" Ice Bin	11 lbs.	2
SSC-PT	33-3/4" x 22-3/4"	For Pass-Thru Ice Bin	12 lbs.	2

**For Older Style Ice Bins Prior To 2015*

DETAILS and SPECIFICATIONS

TOL Overall: ± .500" Interior: ± .250"

ALL DIMENSIONS ARE TYPICAL

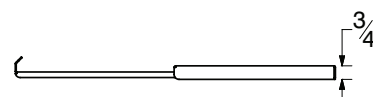
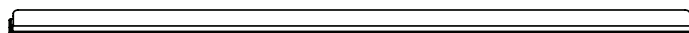
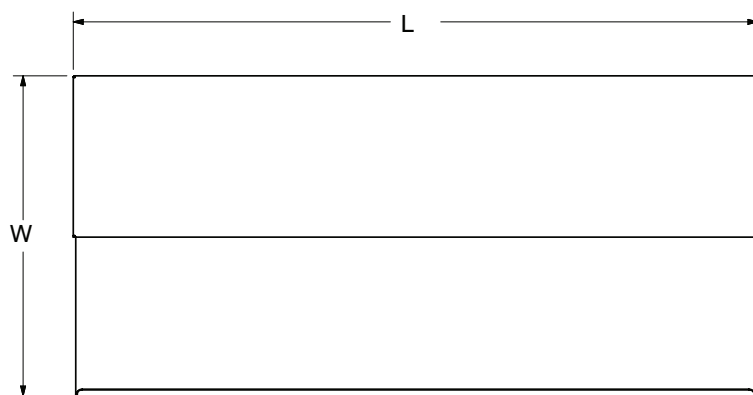

Customer Service Available To Assist You 1-800-645-3166 8:30 am - 7:00 pm E.S.T.

For Orders & Customer Service:

Email: customer@advancetabco.com or Fax: 631-242-6900

For Smart Fabrication™ Quotes:

Email: smartfab@advancetabco.com or Fax: 631-586-2933