

FE SERIES - FABRICATED SINKS



One & Two Compartments



Rolled Rim Edge
For Additional Strength

Item #: _____ Qty #: _____

Model #: _____

Project #: _____

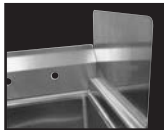

K-700

Removable Side
Splashes Fits Left
OR Right Side

	MODEL #	Length L	Width W	Bowl Size A & B	Bowl Depth	Drbd. Length C	# of Drbrds.	Drbd. Location	Wt	Aprox. Cubes
1 COMP.	FE-1-1515-PX	20"	20 3/4"	15"x15"	12"	N/A	0	None	38 lbs.	11
	FE-1-1514-15RLPX	45"	20 3/4"		14"	N/A	0	R & L	65 lbs.	11
	FE-1-1620-PX	21"	25 3/4"	16"x20"	12"	N/A	0	None	42 lbs.	12
	FE-1-1620-18RorL-PX	36 1/2"	25 3/4"		12"	18"	1	R or L	55 lbs.	18
	FE-1-1812-PX	23"	23 3/4"	18"x18"	12"	N/A	0	None	42 lbs.	13
	FE1-1812-18RorL-PX	38 1/2"	23 3/4"		12"	18"	1	R or L	57 lbs.	22
	FE1-1812-18RLPX	54"	23 3/4"	18"x24"	12"	18"	2	R & L	65 lbs.	23
	FE-1-1824-PX	23"	29 3/4"		14"	N/A	0	None	60 lbs.	16
	FE-1-1824-24RorL-PX	44 1/2"	29 3/4"	18"x24"	14"	24"	1	R or L	105 lbs.	28
	FE-1-2424-PX	29"	29 3/4"		14"	N/A	0	None	90 lbs.	20
2 COMP.	FE1-2424-24RLPX	72"	29 3/4"		14"	24"	2	R & L	122 lbs.	44
	FE-2-1620-PX	37"	25 3/4"	16"x20"	12"	N/A	0	None	72 lbs.	18
	FE-21620-18RLPX	68"	25 3/4"		12"	18"	2	R & L	100 lbs.	32
	FE-2-1812-PX	41"	23 3/4"	18"x18"	12"	N/A	0	None	65 lbs.	18
	FE-2-1812-18RorL-PX	56 1/2"	23 3/4"		12"	18"	1	R or L	78 lbs.	26
	FE2-1812-18RLPX	72"	23 3/4"	18"x24"	12"	18"	2	R & L	84 lbs.	44
	FE2-2424-24RLPX	96"	29 3/4"		14"	24"	2	R & L	140 lbs.	50

FEATURES:

Backsplash has tile edge for ease of installation.
Sink bowls are 3/4" coved corner and meet NSF requirements
Rolled Rim Edge for additional strength.
15"x15", 16"x20" & 18"x18" Sink Bowls are 12" deep.
18"x24" & 24"x24" Sink Bowls are 14" deep.
9" Backsplash.

CONSTRUCTION:

All TIG welded.
Welded areas blended to match adjacent surfaces
and to a satin finish.
Gussets welded to a die-embossed reinforced plate.

MATERIAL:

1 5/8" diameter galvanized legs with
1" adjustable plastic bullet feet.
Entire unit is 18 gauge 304 stainless steel.
Gussets - galvanized steel.

MECHANICAL:

- Supply is 1/2" IPS hot & cold.
- Faucet holes on 8" centers.
- Faucets are not included (**see accessories**).
- Waste drains are 1 1/2" IPS S/S basket type, located
in center of sink bowl, and are included.

OPTIONAL:

- **FE-SS-12** S/S Leg Upgrade For Sinks w/ 12" Deep Bowls
- **FE-SS-14** S/S Leg Upgrade For Sinks w/ 14" Deep Bowls

DIMENSIONS and SPECIFICATIONS

TOL Overall: $\pm .500''$ Interior: $\pm .250''$

ALL DIMENSIONS ARE TYPICAL

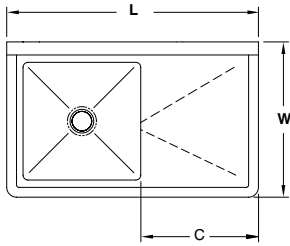

1 COMP - 1 DRBD

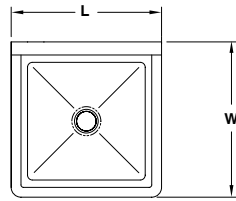

1 COMP

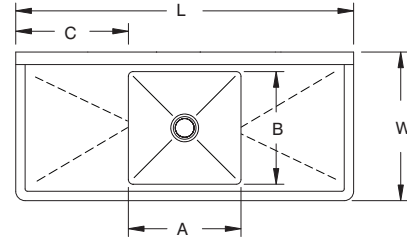

1 COMP - 2 DRBD

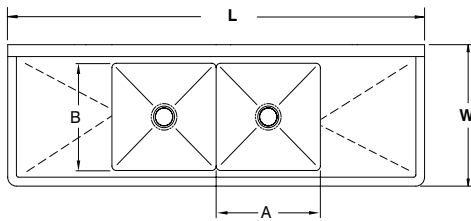

2 COMP - 2 DRBD

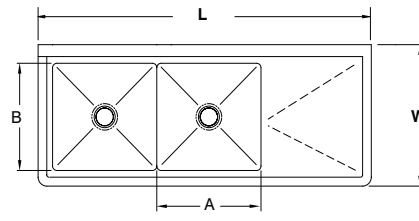

2 COMP - 1 DRBD

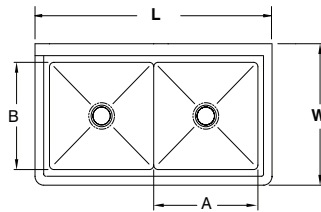

2 COMP

ACCESSORIES

	Model #	Qty
DRAINS		
FAUCETS		

